

# Protek 868 Clamp



## Protek 868

### Double Wire Panel System

The Protek 868 is also available with clamp fixing to the post, giving added security to your industrial, retail and sports installation. This is a flat panel system using twin horizontal wires 8mm in diameter, welded to a 6mm vertical wire. The panel is fixed to the post with a 40 x 5mm flat clamp bar.

### Product and Finish Standards

- Mesh panel wire manufactured to BS 4102 and galvanised to BS EN 10244-2:2001 class D, weld strength is 75% of the minimum tensile strength of the wire (tensile range 540-690 N/m<sup>2</sup>)
- Post material manufactured to BS EN 10210-2:1997 and galvanised to BS EN 10346:2009
- Panels & Posts are powder coated to BS EN 13438:2005 (min 100 micron)

### Posts, Clamps and Fixings

The posts and full length clamp bars that Alexandra Security Limited offers provide a fixing system which secures the panels but allows for variations. The system is easy to install and allows the panels to be stepped, helping the fence line to follow the contours of the ground. With the vandal resistant security fixings this post and clamp system provides a higher level of security than the traditional clip system.

### Options

- Panels can be inverted to create flat top option
- Other heights available on request
- Rubber backstops are available for all fixings for anti-vibration

Nominal Fence Height (m)	Panel Size Height x Width (mm)	Overall Length of Post (mm)	Post Size (mm)	Number of Fixings	
				Ends/Inters (1 Clamp)	Corners (2 Clamps)
1.0	1,030 x 2,506	1,400	60 x 40	4	8
1.2	1,230 x 2,506	1,850	60 x 40	4	8
1.8	1,830 x 2,506	2,400	60 x 40	8	16
2.0	2,030 x 2,506	2,700	60 x 40	9	18
2.4	2,430 x 2,506	3,200	60 x 40	10	20
3.0	3,030 x 2,506	3,750	80 x 40	12	24
3.1*	3,060 x 2,506	3,750	80 x 40	13	26

\*Double lift 3.1m high

Subject to change

- 1 Mesh panel - mesh size 200 x 50mm - 1 x 6mm vertical and 2 x 8mm horizontal wire
- 2 Post size varies with height (see table)
- 3 Clamp bar 40 x 5mm flat bar (full length of mesh panel)
- 4 Plastic cap varies with post size (see table)
- 5 M8 x 40 Stainless steel, security screw

Intermediate post

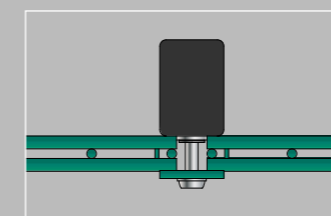

End post

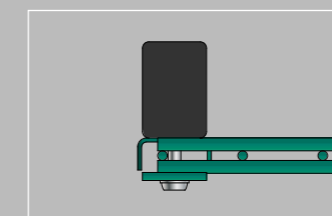

Internal corner post

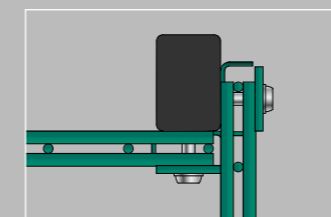

External corner post

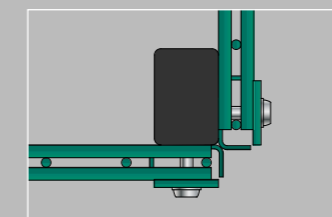

### Suitable For:

Schools, Ball Parks,  
Sports Facilities, Retail Parks,  
Business Parks



For more details on this product please visit our website:  
[www.alexandrasecurity.com/general-mesh](http://www.alexandrasecurity.com/general-mesh)