

# Protek 868 Rebound Sports Mesh

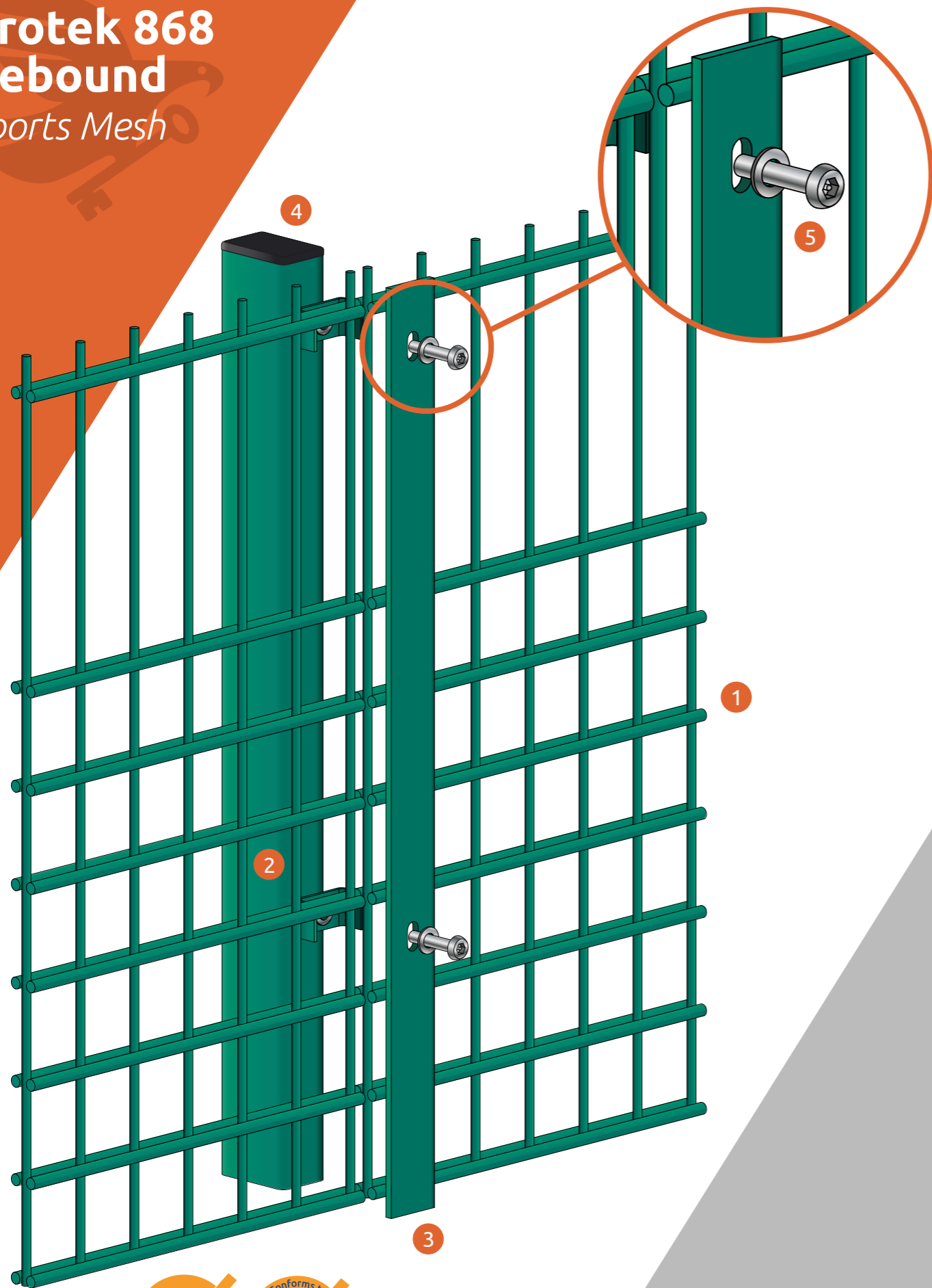

For more details on this product please visit our website:  
[www.alexandrasecurity.com/sports-mesh](http://www.alexandrasecurity.com/sports-mesh)

*Suitable For:*

*Multi-use games area,  
 Schools and Sports pitches*

## Protek 868 Rebound

### Double Wire System

The Protek 868 Rebound mesh fence system has been designed for use around multi-use ball game areas. The standard panel is 2.0m high with the wire spacing on the lower 1200mm of the panel being 66.6 x 50mm and the remaining 800mm above being 200 x 50mm. The closer wire centres on the lower part of the panel give it high rebound properties, helping the ball to rebound back into the court.

### Product and Finish Standards

- Mesh panel wire manufactured to BS 4102 and galvanised to BS EN 10244-2:2001 class D, weld strength is 75% of the minimum tensile strength of the wire (tensile range 540-690 N/m<sup>2</sup>)
- Post material manufactured to BS EN 10210-2:1997 and galvanised to BS EN 10346:2009

### Posts, Clamps and Fixings

The posts and full-length clamp bars that Alexandra Security Limited offers provide a fixing system which secures the panels but allows for variations. The system is easy to install and allows the panels to be stepped, helping the fence line to follow the contours of the ground. With the vandal resistant security fixings this post and clamp system provides a higher level of security than the traditional clip system.

- Panels & Posts are powder coated to BS EN 13438:2005 (min 100 micron)

### Options

- Standard Rebound panel and Full-Height Rebound panel
- Other heights available on request

Nominal Fence Height (m)	Panel Size Height x Width (mm)	Post Size (mm) Ends/Iners	Post Size (mm)		Overall Length of Post (mm)	Number of Fixings	
			Internal Corner	External Corner		Ends/Iners (1 Clamp)	Corners (2 Clamps)
2.0	2,030 x 2,506	60 x 40	60 x 40	60 x 60	2,700	9	18
2.4**	2,400 x 2,506	60 x 40	60 x 40	60 x 60	3,200	10	20
3.0	3,030 x 2,506	80 x 40	80 x 40	80 x 80	3,900	12	24
3.1*	3,060 x 2,506	80 x 40	80 x 40	80 x 80	3,900	13	26
3.6*	3,660 x 2,506	80 x 40	80 x 40	80 x 80	4,600	15	30
4.0*	4,060 x 2,506	100 x 50	100 x 50	80 x 80	5,100	16	32
4.5*	4,460 x 2,506	100 x 50	100 x 50	80 x 80	5,500	19	38
5.0*	5,060 x 2,506	100 x 50	100 x 50	80 x 80	6,200	21	42
6.0*	6,080 x 2,506	120 x 60	120 x 60	100 x 100	7,500	24	48

\*Made of multiple panels and clamp bars \*\*Panel supplied without spikes

Subject to change

- 1 Mesh panel - mesh size 66.6 x 50mm up to 1200mm high then wire spacing at 200 x 50mm - 1 x 6mm vertical and 2 x 8mm horizontal wire
- 2 Post size varies with height (see table)
- 3 Clamp bar 40 x 5mm flat bar (full length of mesh panel)
- 4 Plastic cap varies with post size (see table)
- 5 M8 x 40 Stainless steel security screw

Intermediate post

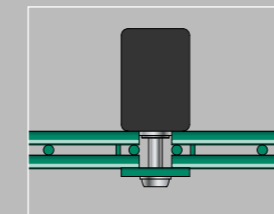

End post

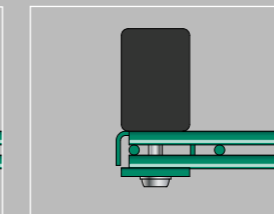

Flanged external corner

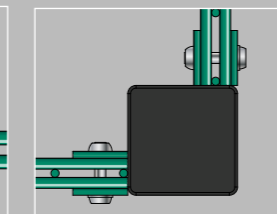

Clipped internal corner post

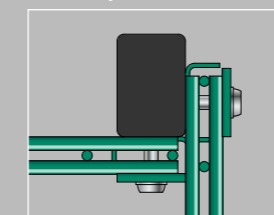

Clipped external corner post

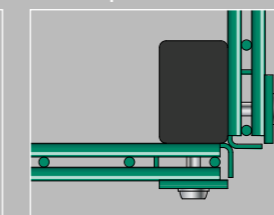

# Protek 868 Rebound