

# Sports Accessories

## Sports Mesh

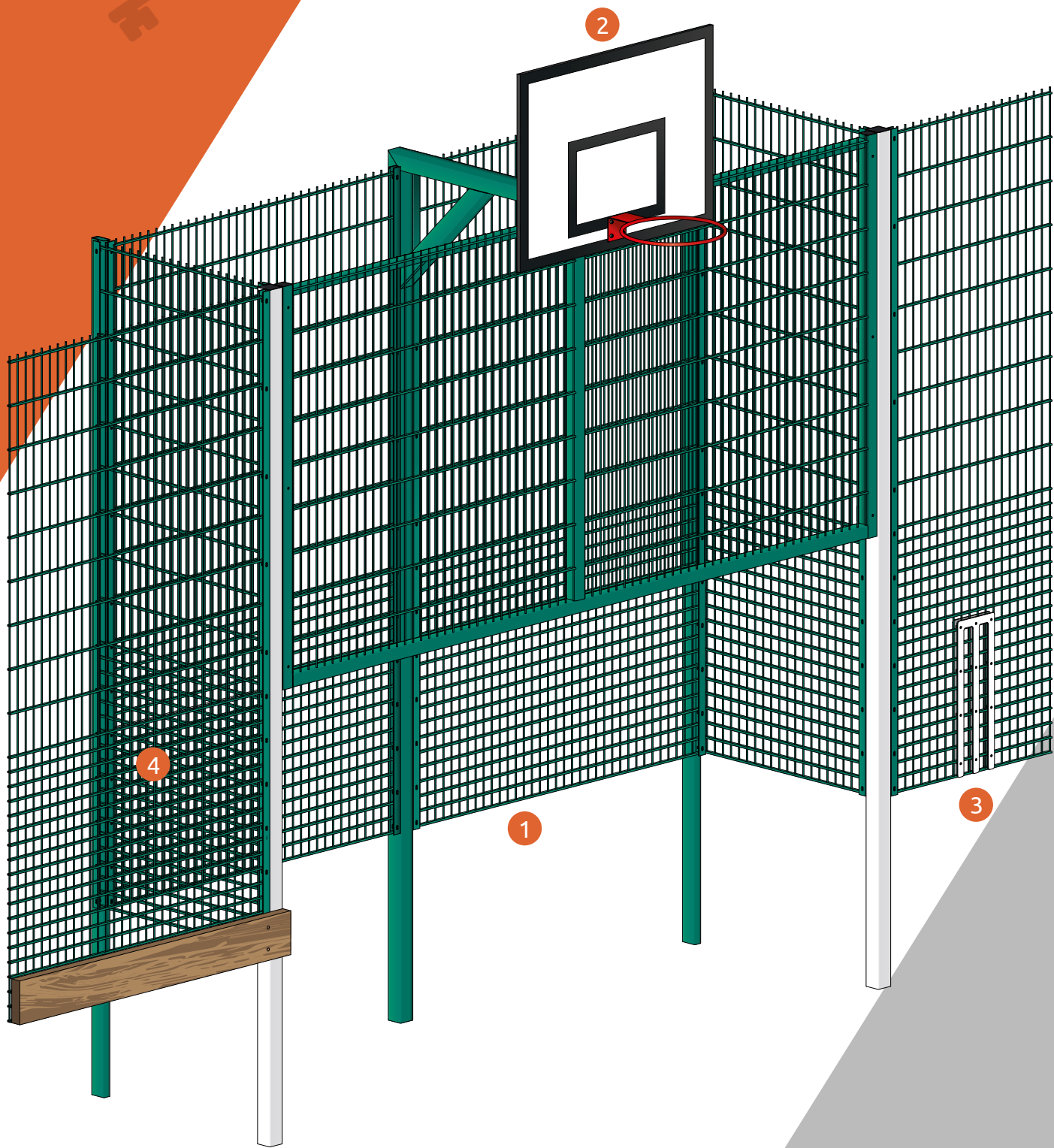

For more details on this product please visit our website:  
[www.alexandrasecurity.com/sports-mesh](http://www.alexandrasecurity.com/sports-mesh)

# Sports Accessories

Alexandra's Protek 656 and 868 Rebound sports mesh and Protek Spectator Rail can be used to enclose anything from a sports field to a tennis court, but for customers looking for the whole package Alexandra has a range of accessories to complete your installation, all made and finished to the same high standards as the perimeter mesh you've selected.

Not all designers have the luxury of space, and some often have to apply creative solutions to ensure that the maximum number of sports and users can take advantage of the same area. Play not only has to remain within the designated area (especially when close to homes and businesses) but all users have to be able to play freely in a safe environment. At Alexandra we ensure that all courts are designed and finished to the highest standards taking into account all the latest regulations and recommendations from the relevant sporting bodies.

The recessed goal illustrated on the opposite page is integrated into the fence line. These are available in any size required, but a table below will help you specify something that fits with your requirement. We've also shown how a basketball unit can be integrated into the design. This can be placed on one of the extended fence posts, or the hoop and back board can be attached directly to the mesh panel that sits above the goal mouth crossbar.

The important thing to remember is that whatever your requirement Alexandra will be there to help with the solution, providing bespoke CAD drawings to help you visualise how your new sports facility will look and function.



## FA Goalpost Sizes

Age	Height (ft)	Width (ft)
Mini Soccer (U7 – U10)	6	12
Youth (U11 – U12)	7	16
Youth (U13 – U14)	7	21
Youth / Adult (U15 +)	8	24

Subject to change

- 1 Our goal recesses can be made in a range of sizes depending on the planners age range (please refer to table above) – lintel type, as shown here, and full-height, and similar constructions can be made to suit a range of outdoor ball games
- 2 Complete basketball system including post, backboard and net
- 3 Laser cut components – Cricket stumps
- 4 Mesh systems can extend all the way down to the sports surface, or timber kick boards and supporting lugs can be included at manufacture to conform to your sports requirement

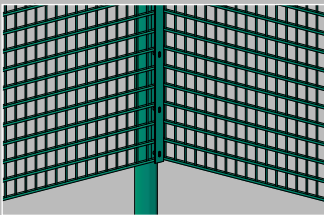

Rebound mesh

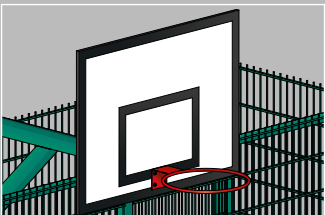

Basketball hoop

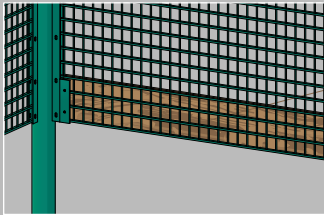

Kick board

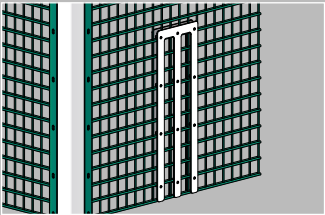

Laser cut cricket stumps