

DATASHEET | V2.0 - 05/26

Protek[®] 868 Clip

TWIN-WIRE CLIP SYSTEM

The Protek 868 Clip system features twin-wire mesh panels that provides a versatile fencing system that is stronger than single-wire systems.

By using twin 8mm diameter horizontal wires between the vertical wire, Protek 868 is much harder to cut through, making it an ideal perimeter fencing solution where higher security is needed. In this clip system, adjoining panels are held together with metal clips that are then clamped into posts using pre-drilled holes with inserts.

SUITABLE FOR:

- Schools & Colleges
- Public Areas
- Retail Parks
- Sport Facilities



 **MADE IN BRITAIN**



Other RAL colours available as special order



Nominal Fence Height (m)	Panel Size Height x Width (mm)	Post Centres (mm)	Overall Length of Post (mm)	Post Size (mm)	Number of Fixings	
					Per Post	Per Corner
1.2	1,230 x 2,506	2,520	1,800	60 x 60	4	8
1.8	1,830 x 2,506	2,520	2,400	60 x 60	5	10
2.0	2,030 x 2,506	2,520	2,600	60 x 60	6	12
2.4	2,430 x 2,506	2,520	3,100	60 x 60	7	14
3.0	3,030 x 2,506	2,520	3,750	60 x 60	8	16

DATA SUBJECT TO CHANGE

DATASHEET | V2.0 - 05/26

Protek[®] 868 Clip

TWIN-WIRE CLIP SYSTEM

Product Technical Information

- Panels:**
- Mesh size 200 x 50mm.
 - 1 x 6mm vertical and 2 x 8mm horizontal wire.
 - Panels can be inverted to create flat top option.
 - Manufactured to BS 4102 and galvanised to BS EN 10244-2:2001 class D.
 - Weld strength is 75% of the minimum tensile strength of the wire (tensile range 540-690 N/m²).
- Posts:**
- Dig-in posts. Post size varies with height (see table).
 - Post material manufactured to BS EN 10210-2:1997 and galvanised to BS EN 10346:2009.
 - Supplied with plastic cap (size varies with height (see table)).
- Fixings:**
- Clamp Bar: 40 x 5mm (full length of mesh panel).
 - M8 x 40 Fourtress tamper resistant hardened steel security screw.
 - Rubber backstops are available for all fixings for anti-vibration.
- Finish:**
- Panels & Posts are galvanised before being powder coated to BS EN 13438:2005 (min 100 micron).
 - Standard colour is RAL 6005 (Moss Green).
 - Other RAL colours available as special order, including marine grade coating.
- Post Options:**
- Cranked posts (internal and external / top and bottom).
 - Face fix (for flush against walls).
 - Base-plated (flush to front, back or centrally) available as special order for installation onto concrete and other hard surfaces.

While care has been taken to ensure that all information provided on this data sheet is accurate, Alexandra Security reserves the right to change product specifications at any time. E&OE.



Intermediate post

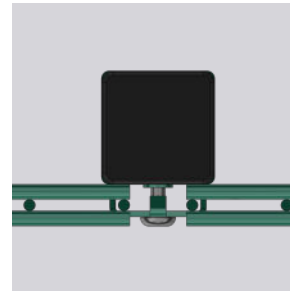

End post

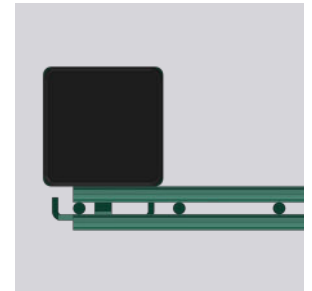

Internal corner post

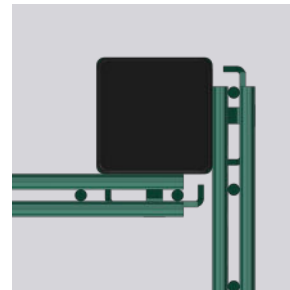

External corner post

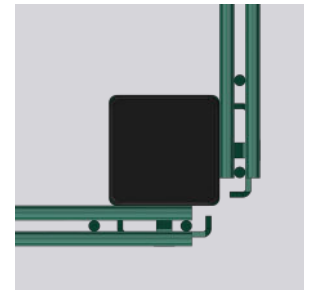

POSTS & FIXINGS



The post and clip system offers a reliable fixing solution that secures panels firmly while allowing for flexibility. Simple to install, each post features additional insert holes that enable the panels to be stepped or angled, following the natural contours of the ground. Combined with vandal-resistant security fixings, this system provides a solid level of security for any boundary.



We are able to offer a 15-year guarantee, covering the performance and appearance of our mesh fencing systems. Giving you added confidence when specifying an Alexandra product.