



Non-Standard

Fence Options

In perimeter security fencing, no two jobs are the same, so to help our customers with finished solutions that match their specification we have a range of construction options that can be included at the manufacturing stage.

Base plated posts are ideal for when traditional dig-in posts are not suitable, allowing for fence posts to be securely mounted onto concrete. We also can provide a face fix mounting system for setting the fence line against a wall.

If you have a special project that requires a solution not covered by the above, please contact our estimating team to discuss how we can best achieve your goals. All our project work is supported with detailed CAD drawings.

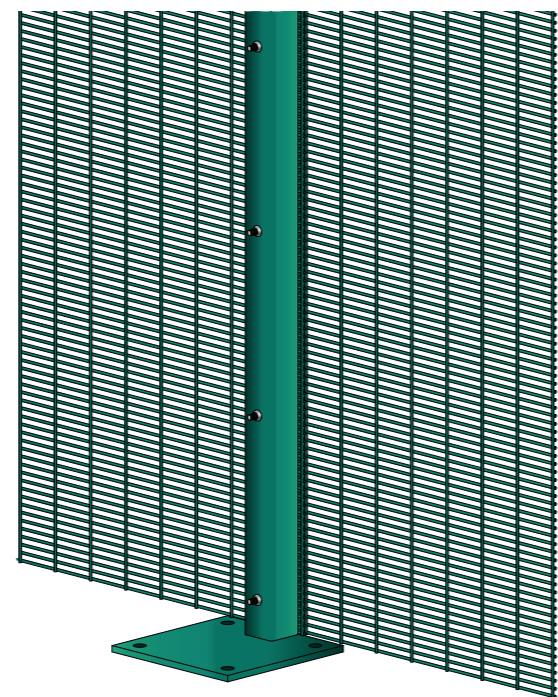

Base Plated

For installation on concrete and other hard surfaces. Post can be positioned flush to front, back or centrally, or to customer specifications.

Spigotted Base Plates

Fitting directly onto existing dig-in posts, the Spigotted Base Plate allows posts to be converted to a bolt-down fitting for installation into hard surfaces.

(only suitable for 60x60mm SHS posts)



Cranked Posts - Top

Typically used to add extra anti-climb features using razor or barbed wire. Crank can be manufactured to customer's exact specifications.

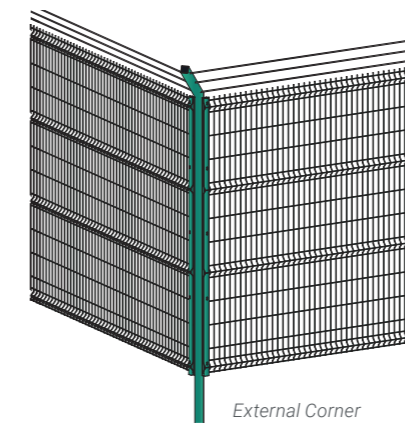
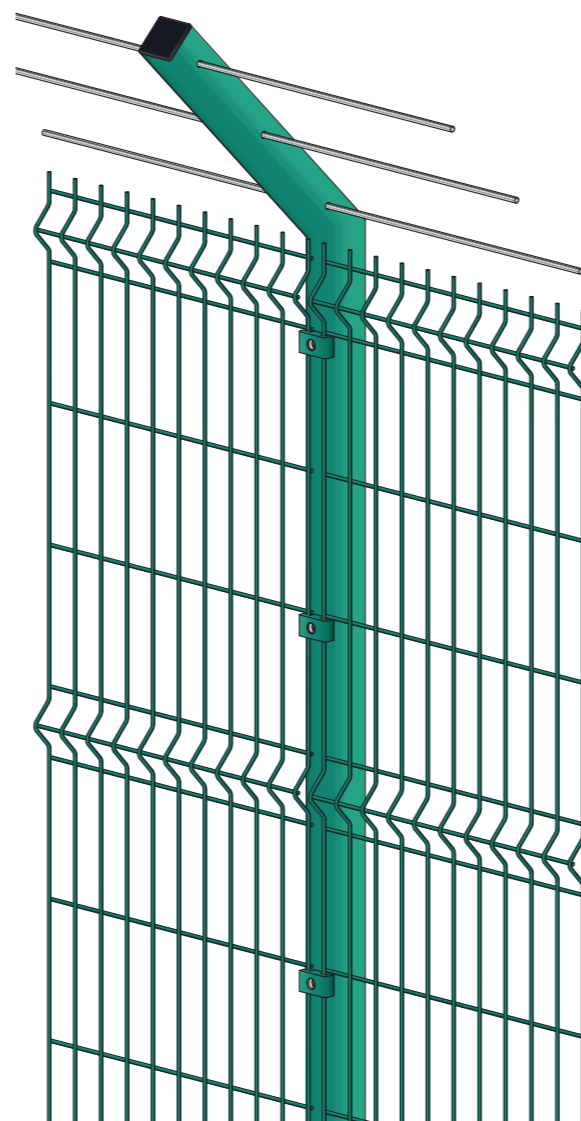

External Corner

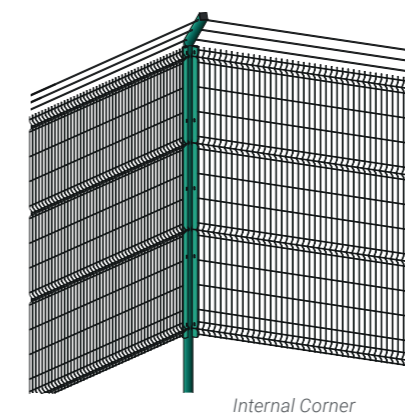

Internal Corner

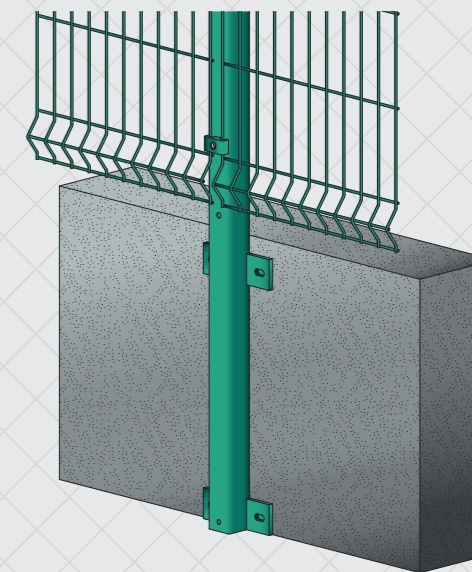

Face Fix

Setting the mesh flush with the back or front of the wall.

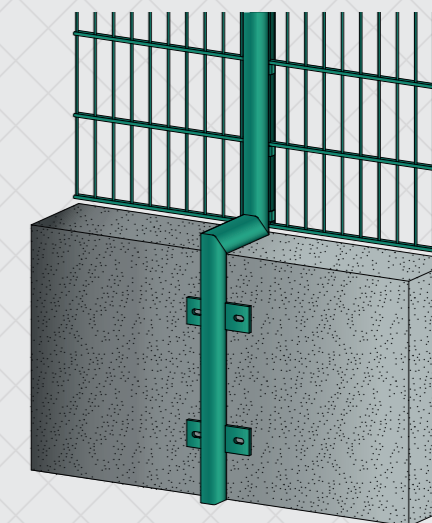

Cranked Post - Bottom

Flush to back or front of wall. Can be made to customer's exact specifications.