



Protek[®] 868 Clip

Twin-Wire Clip Fence System

The Protek 868 Clip system features twin-wire mesh panels that provides a versatile fencing system that is stronger than single-wire systems.

By using twin 8mm diameter horizontal wires between the vertical wire, Protek 868 is much harder to cut through, making it an ideal perimeter fencing solution where higher security is needed. In this clip system, adjoining panels are held together with metal clips that are then clamped into posts using pre-drilled holes with inserts.



Applications

- Schools and Colleges
- Sports Facilities
- Retail Parks
- Business Parks



Other RAL colours available as special order



Specification

Nominal Fence Height (m)	Panel Size Height x Width (mm)	Post Centres (mm)	Overall Length of Post (mm)	Post Size (mm)	Number of Clips	
					Per Post	Per Corner
1.2	1,230 x 2,506	2,520	1,800	60 x 60	4	8
1.8	1,830 x 2,506	2,520	2,400	60 x 60	5	10
2.0	2,030 x 2,506	2,520	2,600	60 x 60	6	12
2.4	2,430 x 2,506	2,520	3,100	60 x 60	7	14
3.0	3,030 x 2,506	2,520	3,750	60 x 60	8	16

Data subject to change

Protek[®] 868 Clip

DATASHEET

Version 1.2 | 02-26



Posts, Clips and Fixings

The posts and clips that Alexandra Security offers provide a fixing system which secures the panels but allows for variations. The system is easy to install and allows the panels to be stepped, helping the fence line to follow the contours of the ground. With the vandal resistant security fixings this post and clip system provides a reasonable level of security to any boundary.

Intermediate post

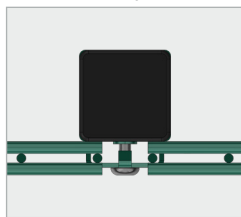

End post

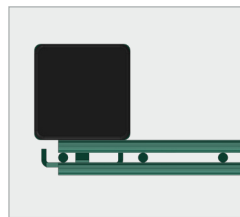

Internal corner post

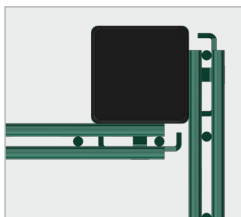

External corner post

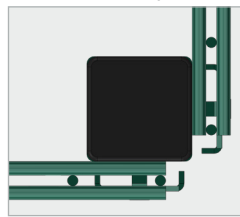

Alexandra Security, Perimeter Works, Whetsted Road,
Five Oak Green, Tonbridge, Kent. TN12 6PZ

www.alexandrsecurity.com | 01892 833 001

Protek is a registered trademark of Alexandra Security Ltd

While care has been taken to ensure that all information provided on this data sheet is accurate, Alexandra Security reserves the right to change product specifications at any time. E&OE.

Product Technical Information

Panels:

- Mesh size 200 x 50mm
- 1 x 6mm vertical and 2 x 8mm horizontal wire.
- Panels can be inverted to create flat top option.
- Manufactured to BS 4102 and galvanised to BS EN 10244-2:2001 class D.
- Weld strength is 75% of the minimum tensile strength of the wire (tensile range 540-690 N/m²).

Posts:

- Dig-in posts. Post size: 60 x 60mm SHS.
- Post material manufactured to BS EN 10210-2:1997 and galvanised to BS EN 10346:2009.
- Supplied with 60 x 60mm plastic cap.
- Post features extra holes for stepping.

Fixings:

- Durable metal clips.
- M8 x 40 Fourtress tamper resistant hardened steel security screw.

Finishings:

- Panels & Posts are galvanised before being powder coated to BS EN 13438:2005 (min 100 micron).
- Standard colour is RAL 6005 (Moss Green).
- Other RAL colours available as special order, including marine grade coating.

Post Options:

- Cranked posts (internal and external / top and bottom).
- Face fix (for flush against walls).
- Base-plated (flush to front, back or centrally) available as special order for installation onto concrete and other hard surfaces.



15 Year Product Guarantee



We work hard to ensure that when you choose Alexandra, there are no shocks or surprises, and that the finished item we deliver looks and functions every bit as well as the initial concept. But should the worst happen we can guarantee that we will not stop until everything has been resolved. In addition, we are able to offer a 15-year guarantee, covering the performance and appearance of our mesh fencing systems. Giving you added confidence when specifying an Alexandra product.

For more information on our product guarantee, please see our website - www.alexandrsecurity.com.

EXCEPTIONAL



4.9 OUT OF 5

feefo

